

CHAINS

RE-ESTABLISHED CORNERS FOR OREGON STATE BOARD OF FORESTRY
(See official plat)

One Quarter corner common to Sections 9 and 10, T1N,
R10W, W.M., Tillamook County, Oregon.

No evidence of original corner found.

RE-ESTABLISHED

Var. 21 1/2 E

Set 1 1/2" x 36" galvanized iron pipe with 3" bronze cap marked "OREGON STATE
BOARD OF FORESTRY 1/4 S9 S10 1961 RS401", 34 inches in ground, and from
which a:

58" Cedar bears N22W 3.9 ft.; scribed 1/4 S9 BT.

72" Cedar bears S71 1/2 E 22.9 ft.; scribed 1/4 S10 BT RS401.

Set 4" x 4" x 52" white painted Cedar post 1.4 ft. N.E. of corner pipe.
Oregon State Board of Forestry metal location poster on 58" Cedar BT.

Var. 21 1/2 E

Section corner common to Sections 1, 6, 7 and 12, T1N,
R9 and 10W, W.M., Tillamook County, Oregon.

No evidence of original corner found.

RE-ESTABLISHED at the point of intersection of the true range line and an
East West line determined by the average of original line blazes found
to the West and East of this point set 1 1/2" x 36" galvanized iron pipe
with 3" bronze cap marked "OREGON STATE BOARD OF FORESTRY T1N R10W R9W
S1 S6 S12 S7 1961 RS401", 34 inches in ground, and from which a:

8" Fir bears S35W 5.7 ft.; scribed T1N R10W S12 BT RS401.

9" Hemlock bears N72W 14.9 ft.; scribed T1N R10W S1 BT.

11" Fir bears S1E 23.9 ft.; scribed T1N R9W S7 BT.

11" Cedar bears N69E 28.9 ft.; scribed T1N R9W S6 BT.

Set 4" x 4" x 52" white painted Cedar post 1.0 ft. S.E. of corner pipe.
Oregon State Board of Forestry metal location poster on 8" Fir BT.
Corner sets in old skid trail course N10E by S10W.

Dated February 27, 1960

Re-established by

Present and witnessed by H. Russell
R. Cop
E. Nylund

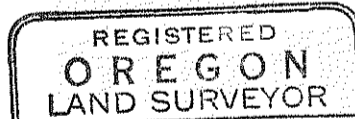

Richard A. Morris
MAY 10. 1957
Richard A. Morris
401